

# FLASH F43XX

4.3" LCD position indicators with audio



## Applications

Car-OP position indicator  
Hall position indicator



## Display features

Up to 2 inches characters  
Automatic centering  
Up to 3 Digits  
Viewing angle of 160 degrees  
64k Colors  
800 x 480 resolution  
Portrait/Landscape



## Audio features

3 watt amplifier  
Voice annunciation  
Arrival Gong  
Fully configurable (WAV/MP3)  
External speaker  
Available only with CANBus



917 Mgr Grandin, Suite 304B  
Quebec City  
Québec, Canada G1V 3X8

1 418 476-4802  
info@vidatechelevator.com

## TO ORDER :

Input  
"0" : Discrete  
"2" : CanBus  
"6" : CanBus + vPixel

## F43XX

Voice  
"0": None  
"1": Arrival gong  
"2": Voice

# F43XX – Binary input 4.3” LCD indicator

## F4300 Binary input 4.3” LCD indicator

No voice

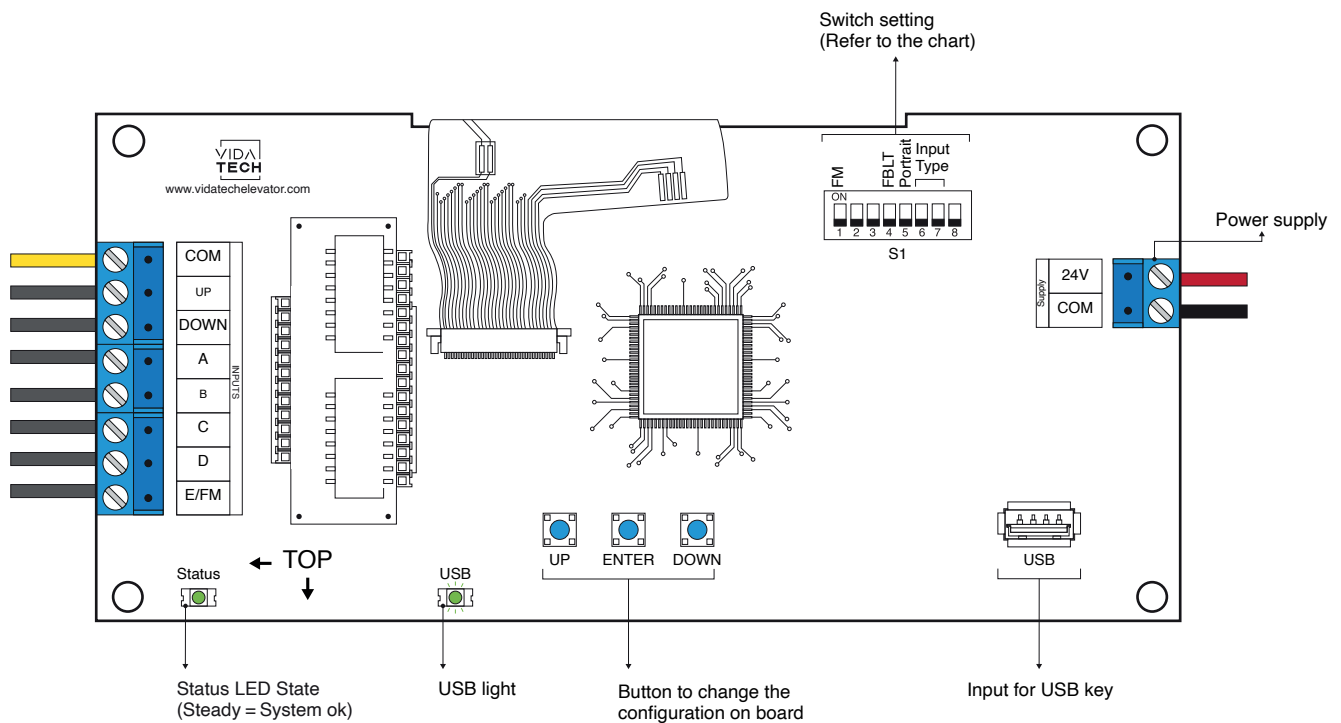

- Supply must be between 16VDC to 28VDC.
- VCI and Visual files must be place on the root of a USB dongle, then connected to a powered indicator until the USB light stops blinking.
- Must be installed in COP or hall fixtures.
- To get the actual configuration of the indicator, connect a void USB dongle, then the configuration will upload into the dongle.
- You can modify the stair digit displayed by the indicator by modifying the .vci file with the Storm software, available on our website.
- You can modify the visual configuration with the Storm software available on our website.
- Switch setting :

SW #	#	Text	Description		
S1	1	FM	ON -> Blank the display in fire mode		
	2				
	3				
	4	FBLT	ON -> 100% backlight intensity OFF -> 80% backlight intensity (Backlight life enhanced)		
	5	Portrait	ON -> Screen Portrait (If configuration supports this mode)		
	Input type		Binary	One wire	Gray code
	6			●	
	7				●
	8				

# F432X – CANBus 4.3” LCD indicator

## F4321 CANBus 4.3” LCD indicator with gong

No voice

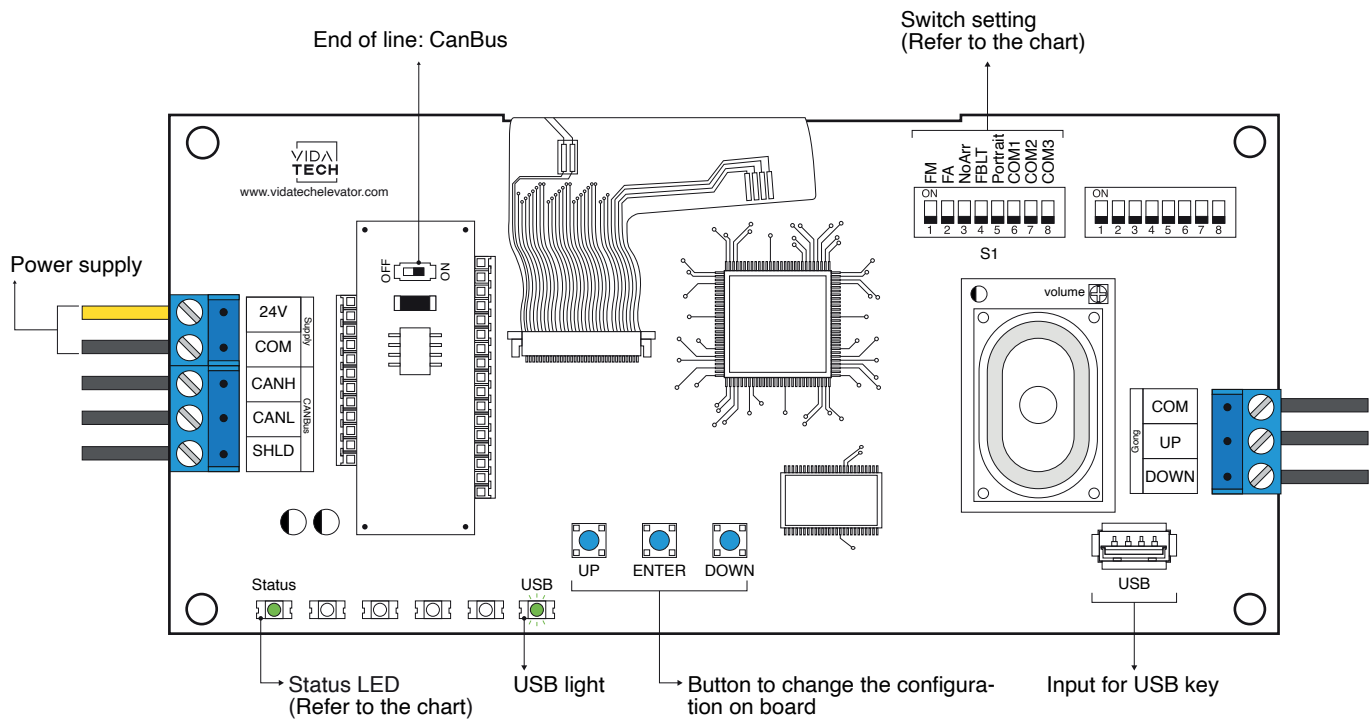

- Supply must be between 16VDC to 30VDC.
- VCI and Visual files must be place on the root of a USB dongle, then connected to a powered indicator until the USB light stops blinking.
- Must be installed in COP or hall fixtures.
- To get the actual configuration of the indicator, connect a void USB dongle, then the configuration will upload into the dongle.
- You can modify the stair digit displayed by the indicator by modifying the .vci file with the Storm software, available on our website.
- You can modify the visual configuration with the Storm software available on our website.
- Press ENTER to go the main menu of the LCD, then navigate with “UP/DOWN” switches. Refer to F4320 operation manual on our website.
- This screen manages special messages.
- To activate Gong option, user must program floor adress in the menu.
- Switch setting :

SW #	#	Text	Description					
S1	1	FM	ON -> Blank the display in fire mode					
	2	FA	ON -> Blank the display in fire alternate mode					
	3	NoArr	ON -> Blank the arrow					
	4	FBLT	ON -> 100% backlight intensity OFF -> 80% backlight intensity (Backlight life enhanced)					
	5	Portrait	ON -> Portrait mode (If existing within the config)					
	Communication		CAN Vidatech	CAN JRT	CAN GAL	CAN elevator controls	CAN TKE	CAN Smartrise
	6	COM1		●		●		●
	7	COM2			●	●		
	8	COM3					●	●

# F432X – CANBus 4.3” LCD indicator

**F4320**  
CANBus 4.3” LCD indicator

No voice

**F4322**  
CANBus 4.3” LCD indicator  
with voice

With voice

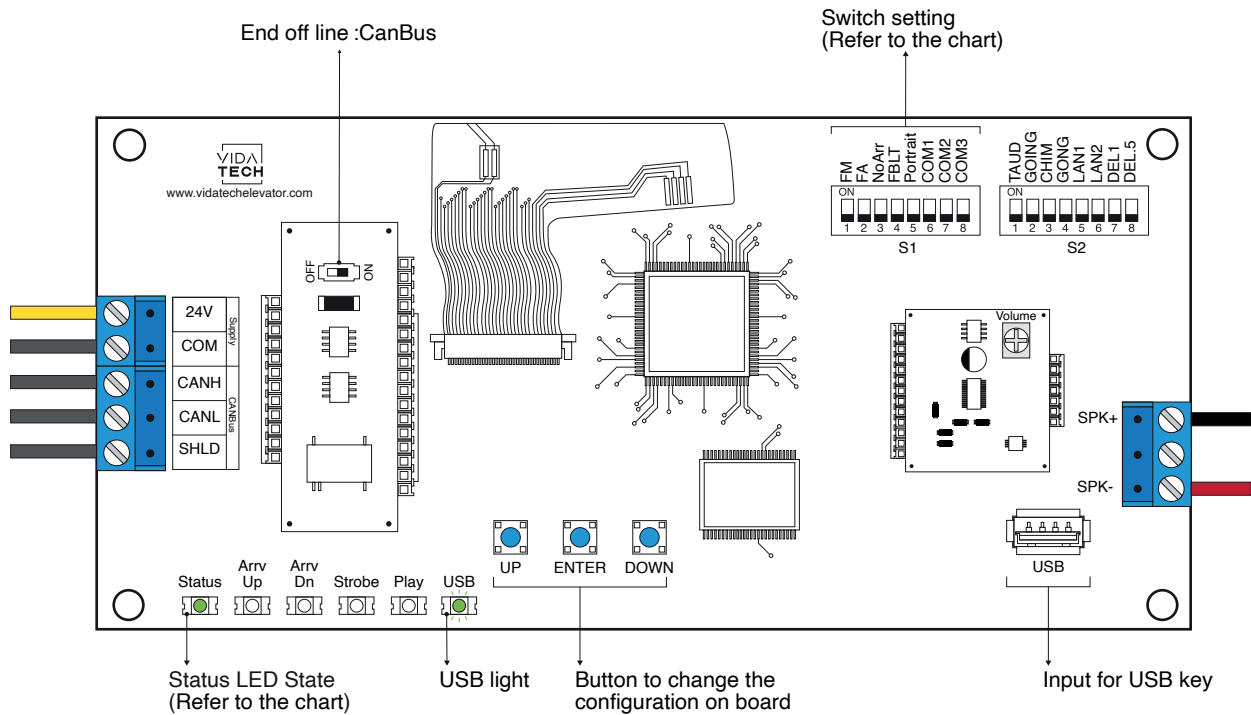

- This screen manages special messages.

- Supply must be between 16VDC to 30VDC.
- Speaker must be 4Ω to 45Ω, 5Watts minimum.
- Up to 12 minutes 38 seconds of message time.
- Speaker wire length must be less than 500 feet to prevent noise.
- .via files are for audio configuration. Only one .via file must be present on the USB dongle.
- .via and visual files must be place on the root of a USB dongle, then connected to a powered voice until the USB light stops blinking.
- Must be installed in COP or hall fixtures.
- To get the actual configuration of the indicator, connect a void USB dongle, then the configuration will upload into the dongle.
- You can modify the stair digit displayed by the indicator by modifying the .vci file with the Storm software, available on our website.
- You can modify the visual configuration with the Storm software available on our website.
- Press ENTER to go the main menu of the LCD, then navigate with UP/DOWN switches. Refer to F4322 operation manual on our website.
- Switch setting :

SW #	#	Text	Description			
S2	1	FM	ON -> Blank the display in fire mode			
	2	FA	ON -> Blank the display in fire alternate mode			
	3	NoArr	ON -> Blank the arrow			
	4	FBL	ON -> 100% backlight intensity OFF -> 80% backlight intensity (Backlight life enhanced)			
	5	Portrait	ON -> Screen portrait (If configuration supports this mode)			
	Communication		CAN Vidatech	CAN JRT	CAN GAL	
	6	COM1		•		
	7	COM2			•	
8	COM3					
S1	1	TAUD	ON -> Play all audio file saved in memory			
	2	GOING	ON -> Going Up/Dn active			
	3	CHIM	ON -> Passing Chime active			
	4	GONG	ON -> Cabin gong active			
	Language		French	English	1 - French 2 - English	1 - English 2 - French
	5	LAN1		•		•
	6	LAN2			•	•
	7	DEL1	ON -> Add 1 second of silence after the strobe			
8	DEL5	ON -> Add 0.5 second of silence after the strobe				

- **Play Test option (TAUD):** The device will play each voice file saved in the system in loop and will display the ASCII associated with the file playing.
- **Going Option (GOING):** The voice will play the file associated with the type « Going UP » or « Going Down » when STRB is asserted AND TRV UP or TRV DN.
- **Chime Option (CHIM):** The voice will play the file associated with the type « CHIME » each time the stair are changing.
- **Gong Option (GONG):** The voice will play the file associated with the type « Gong UP » or « Gong Down » when ARR DN or ARR UP are asserted.

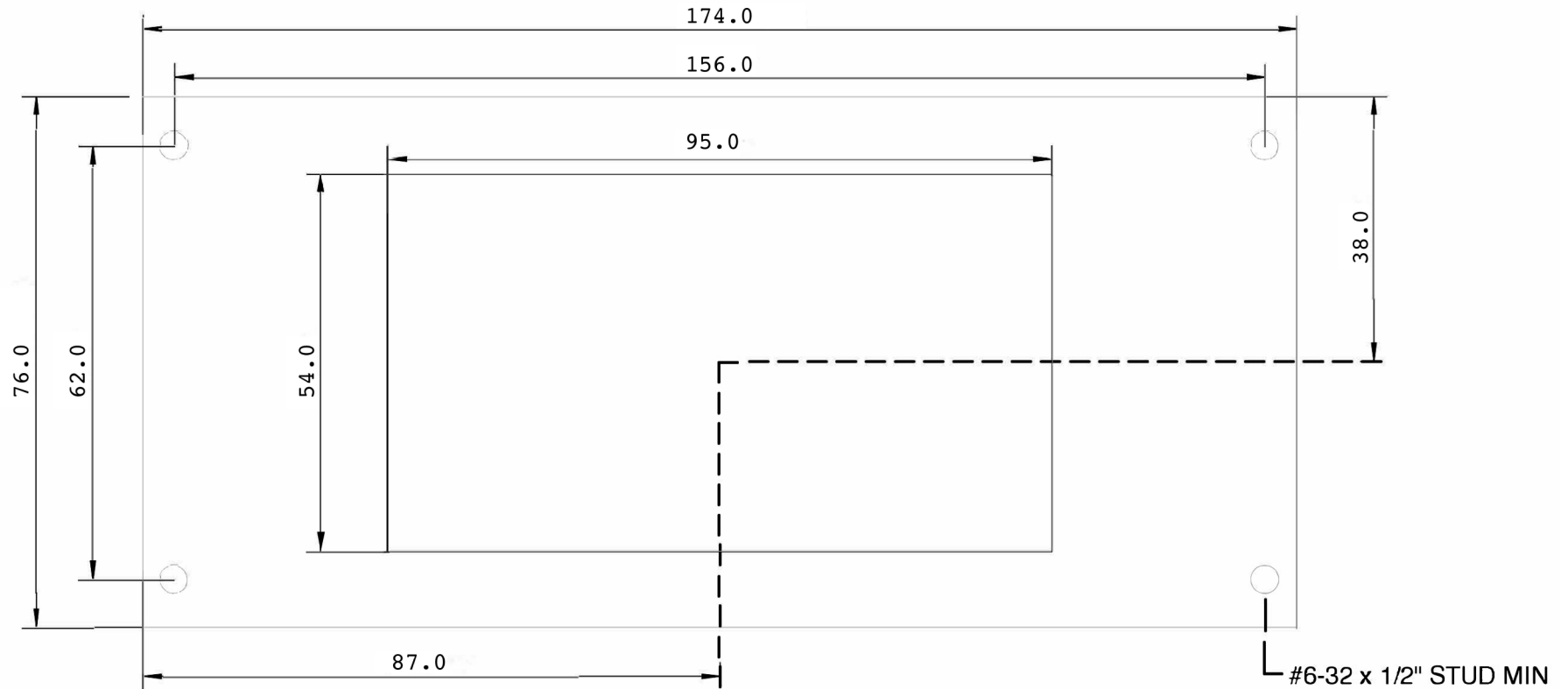

Board thickness: 24 (including lens)

	Title: Face plate cutout detail Flash 4.3"		Unit: MM	
	Tolerance:	Material:	Finish:	
		Scale:	No. piece:	Date: 2021-10-01
	Angular:	Rev: 5	Name: C.L	Page: 1/1



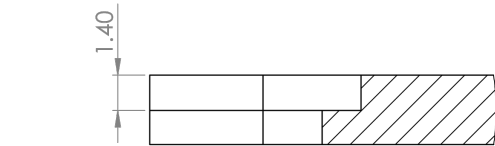
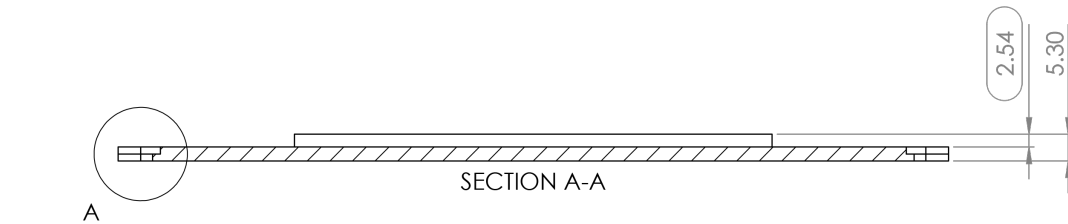
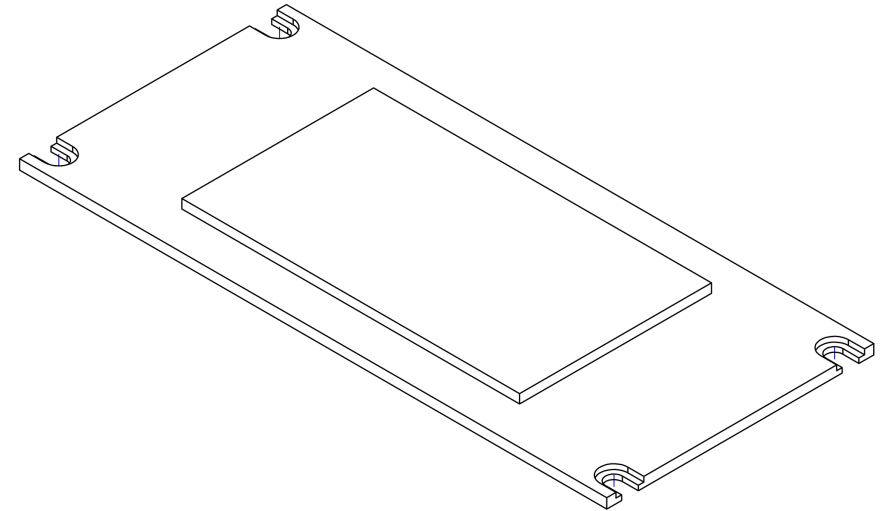
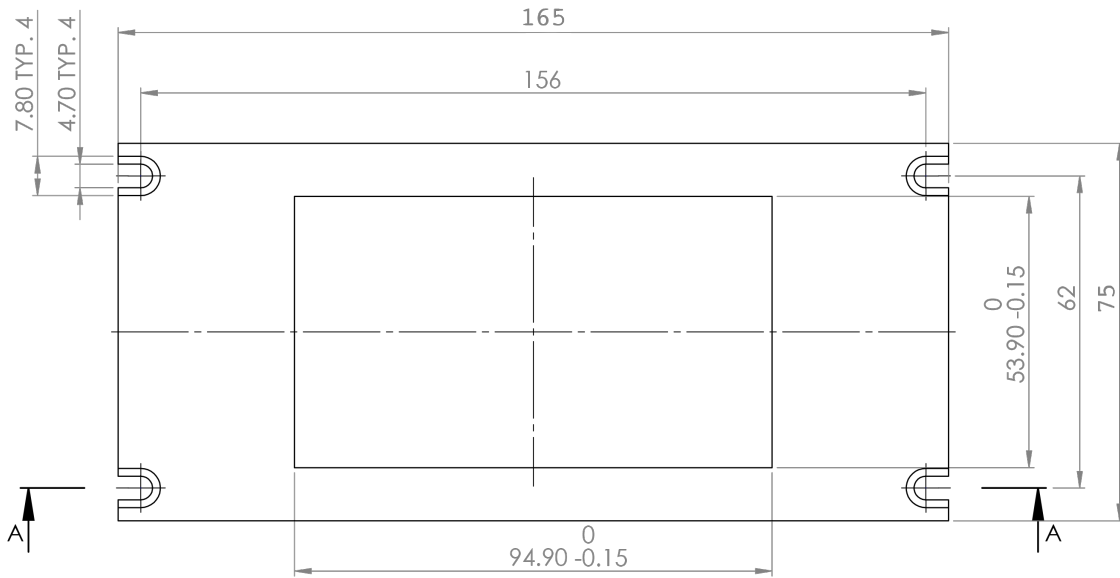

Hole TYP. 4  
DETAIL A  
SCALE 5 : 1

	Title: Lens for screen 4.3"		Unit: MM	
	Tolerance:	Material: Acrylic	Finish: Clear	
		Scale:	No. piece: A43000	Date: 2021-10-01
	Angular:	Rev: 5	Name: C.L	Page: 1/1