

THUNDER

Products for emergency elevator communications

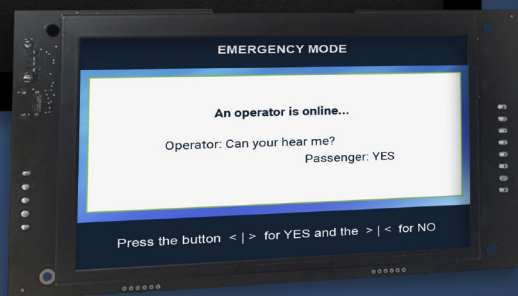

INSTALLATION OF EMERGENCY KIT

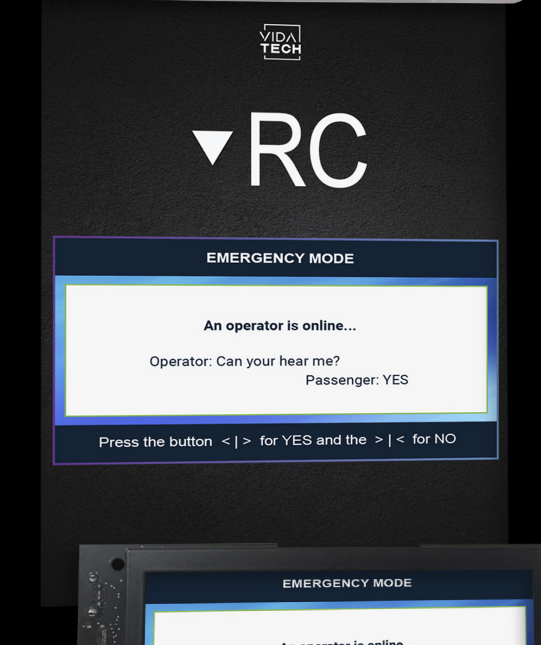
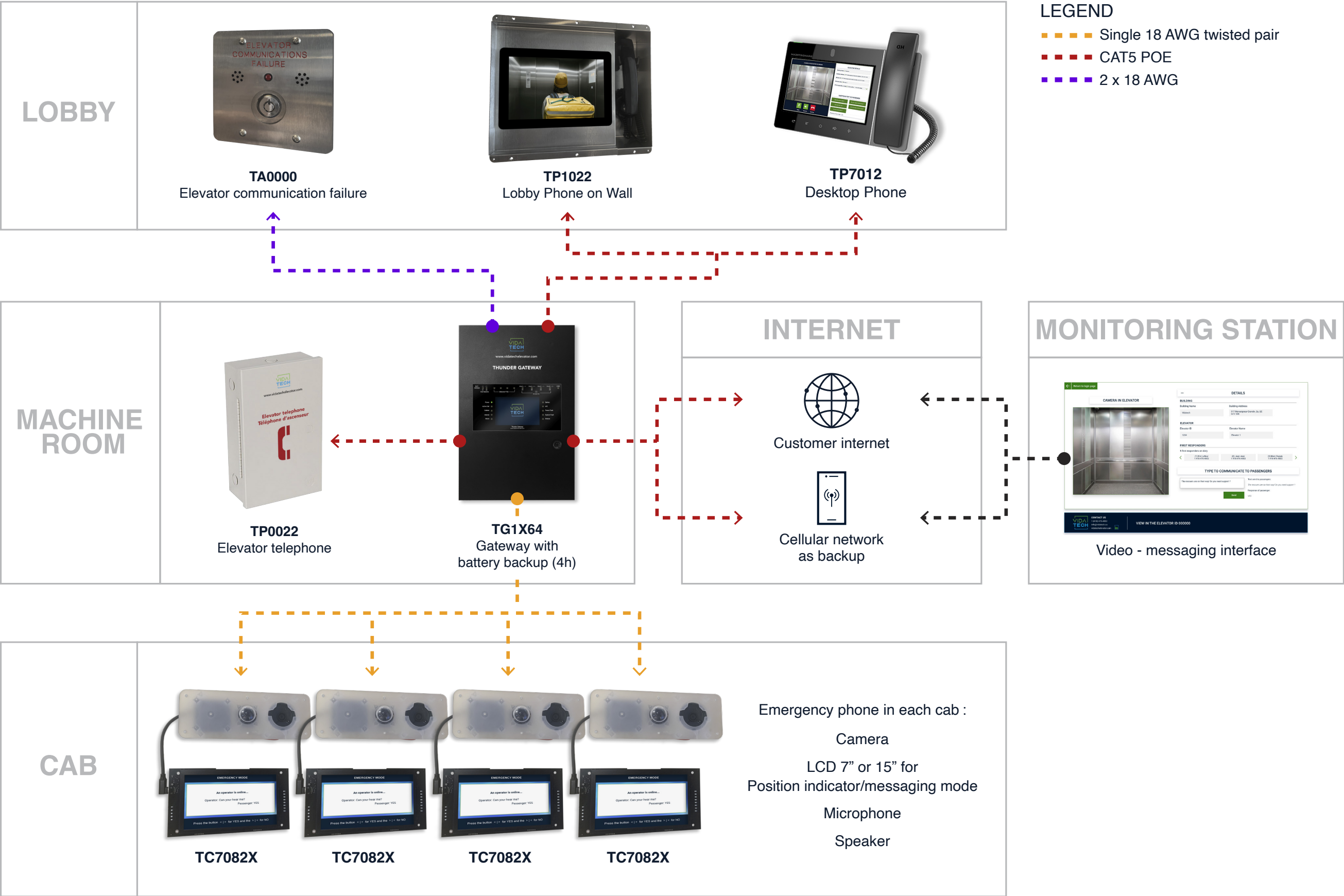

VIDATECH THUNDER. THE SIMPLEST SOLUTION

WHY WORK WITH VIDATECH ?

- Fast client bilingual support
- Engineering and design made internally
- Assemble and tested internally
- Telecommunications expert for better support
- Stand-alone network solutions for peace of mind
- Independent responder platform: No infrastructure required
 - Connect with a link via SMS
 - Connect with a link via email
 - Connect with a 6-digits ID

ADVANTAGES OF THUNDER :

SIMPLE DEVICE CABLING

- No external converter or Ethernet switch required
- Twisted pair or CAT5 for every device
- Centralized battery backup

EASY CONFIGURATION

- Minimum training required
- Dipswitch configurable
- Touchscreen on gateway and Lobby panel for configuration/diagnostics
- Static IP address not required
- Isolated LAN for emergency communication system
- Web configurable with cloud data provisioning
- Bounce-back solution via cellular network available
- No analog line required

SECURITY

- Isolated Network with a firewall
- Encrypted firmware
- Secured building identification
- Locked gateway

MONITORING SERVICES : SELECTED FOR NEEDED SERVICES

- VoIP line
- Monitoring station
- Email/SMS alert on system error
- Visual resources web update
- Building/Product configuration
- Cellular fallback



917 Mgr Grandin, Suite 304B
Quebec City
Quebec, Canada
G1V 3X8
1 418 476-4802
info@vidatech.ca

THUNDER TC7082X

Emergency phone in cab



Emergency call 7" display mode

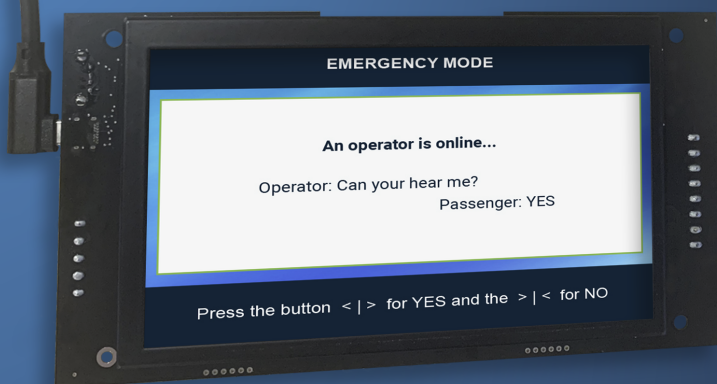

Position indicator 7" display mode



Features

- ADA, ASME A17.1-2019/CSA B44:19 compliant
 - Full-duplex VoIP
 - 7" color LCD
 - LCD position indicator
 - Voice annunciator
- Self-diagnostic as required per code
- Upgradable remotely or with USB drive
 - Dipswitch configurable

Camera module

- Code compliant with entire floor view
- Easy installation in COP: One cable for audio, microphone, video
- External PoE port available as an option



917 Mgr Grandin, Suite 304B
Quebec City
Quebec, Canada
G1V 3X8
1 418 476-4802
info@vidatech.ca

TO ORDER : TC7082X

Ethernet switch
" " : None
"S" : With switch

THUNDER TC1582X

Emergency phone in cab



Emergency call 15" display mode

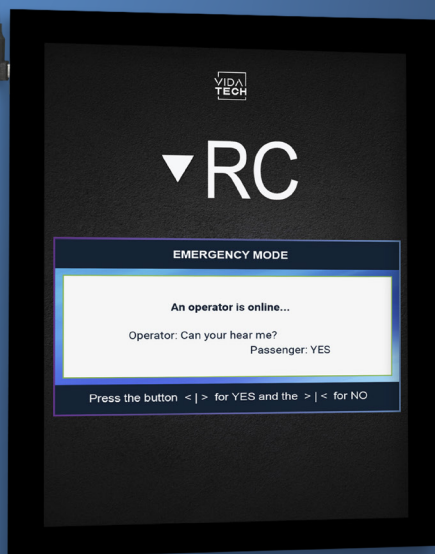

Position indicator 15" display mode



Features

- ADA, ASME A17.1-2019/CSA B44:19 compliant
 - Full-duplex VoIP
 - 15" color LCD
 - LCD position indicator
- Advertising/Announcement display
 - Voice annunciator
- Self-diagnostic as required per code
- Upgradable remotely or with USB drive
- Customizable graphics via web platform
 - Dipswitch configurable

Camera module

- Code compliant with entire floor view
- Easy installation in COP: One cable for audio, microphone, video
- External PoE port available as an option



917 Mgr Grandin, Suite 304B
Quebec City
Quebec, Canada
G1V 3X8
1 418 476-4802
info@vidatech.ca

TO ORDER : TC1582X

Ethernet switch
" ": None
"S": With switch

THUNDER TP0022

Lobby phone



Features and Benefits

- Full-duplex VoIP
- Video communication with cabin
 - Text messaging with cabin
- Powered by PoE (4 hours backup)
 - Web provisioning
- Self-diagnostic as required per code
 - Lockable door



917 Mgr Grandin, Suite 304B
Quebec City
Quebec, Canada
G1V 3X8
1 418 476-4802
info@vidatech.ca

TO ORDER :

TP00X2

Mechanical integration
"1" : OEM
"2" : Surface Mount

THUNDER TP7012

Desktop phone



Features and Benefits

- Full-duplex VoIP
- Video communication with cabin
 - Text messaging with cabin
 - Display all cabin cameras
 - 7" touchscreen LCD display
 - Hands-free mode supported
- Powered by PoE or external source
 - No configuration required



917 Mgr Grandin, Suite 304B
Quebec City
Quebec, Canada
G1V 3X8
1 418 476-4802
info@vidatech.ca

THUNDER TP1022

Lobby phone



Features and Benefits

- Full-duplex VoIP
- Video communication with cabin
 - Text messaging with cabin
 - Display all cabin cameras
- 10.1" touchscreen LCD display
- Powered by PoE (4 hours backup)
 - Dipswitch and web configurable
- Upgradable remotely or with USB drive
- Self-diagnostic as required per code
 - Lockable door



917 Mgr Grandin, Suite 304B
Quebec City
Quebec, Canada
G1V 3X8
1 418 476-4802
info@vidatech.ca

TO ORDER :

TP10X2

Mechanical integration
"1" : OEM
"2" : Surface Mount
"3" : Flush Mount

THUNDER TR002X

Modem LTE

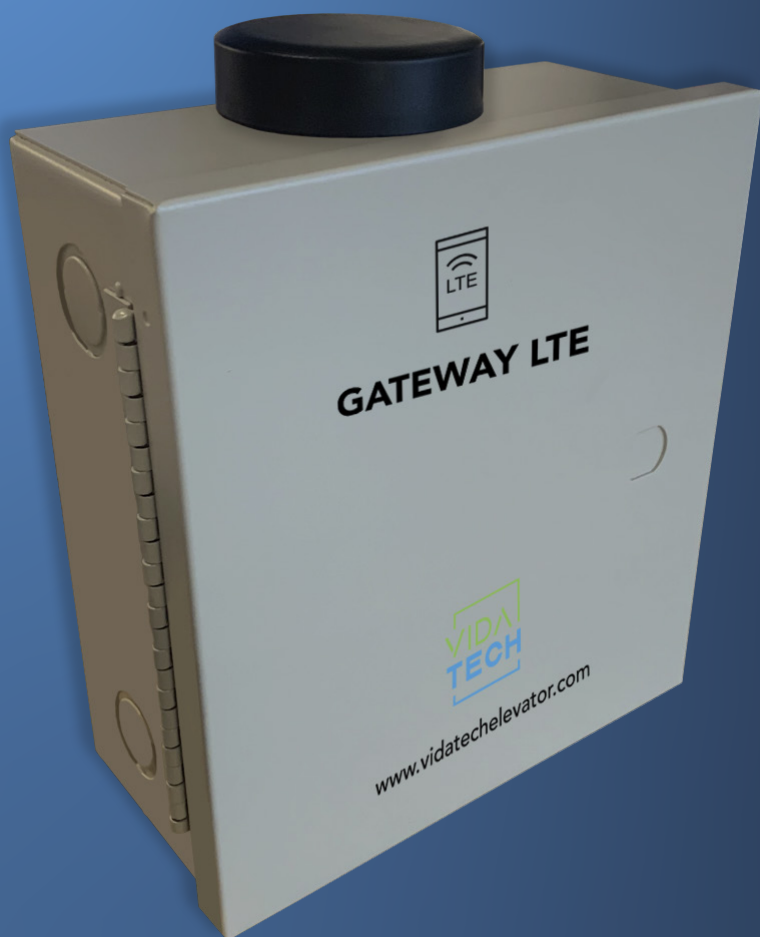

Features and Benefits

- ASME A17.1-2019/CSA B44:19 compliant
- Allows installation without customer-provided ETH
 - POE - powered
 - Lockable door
- Seamless WAN-to-Cellular transfer
 - Subject to monthly - fees



917 Mgr Grandin, Suite 304B
Quebec City
Quebec, Canada
G1V 3X8
1 418 476-4802
info@vidatech.ca

TO ORDER :

TR002X

Mechanical integration
"2" : Surface Mount Enclosure

Antenna
"1" : Puck Antenna

THUNDER TG1X32

Gateway



Features and Benefits

- ASME A17.1-2019/CSA B44:19 compliant
 - Includes 4h+ of battery backup
 - Available for 2 cabins configuration
- Available with 3 POE Ethernet ports
 - 4.3" color LCD
- Constantly diagnoses system state
 - Lockable door
- Multiple Configuration Methods:
 - Through 4.3" touchscreen
 - Through Web platform
 - Through USB drive



917 Mgr Grandin, Suite 304B
Quebec City
Quebec, Canada
G1V 3X8
1 418 476-4802
info@vidatech.ca

TO ORDER :

TG1X32

Battery
"1": With

Supervisor
"0": without
"1": with

Number of
RJ45 POE ports
"3"

Number of
elevators
"2"

THUNDER TG1X64

Gateway



Features and Benefits

- ASME A17.1-2019/CSA B44:19 compliant
 - Includes 4h+ of battery backup
 - Available for 4 cabin configuration
- Available with 4 POE Ethernet ports
 - Available with 2 Ethernet ports
 - 4.3" color LCD
- Constantly diagnoses system state
 - Lockable door
- Multiple Configuration Methods:
 - Through 4.3" touchscreen
 - Through Web platform
 - Through USB drive



917 Mgr Grandin, Suite 304B
Quebec City
Quebec, Canada
G1V 3X8
1 418 476-4802
info@vidatech.ca

TO ORDER :

TG1X64

Battery
"1": With

Supervisor
"0": without
"1": with

Number of
RJ45 POE ports
"6"

Number of
elevators
"4"

THUNDER TA0000

Elevator communication failure

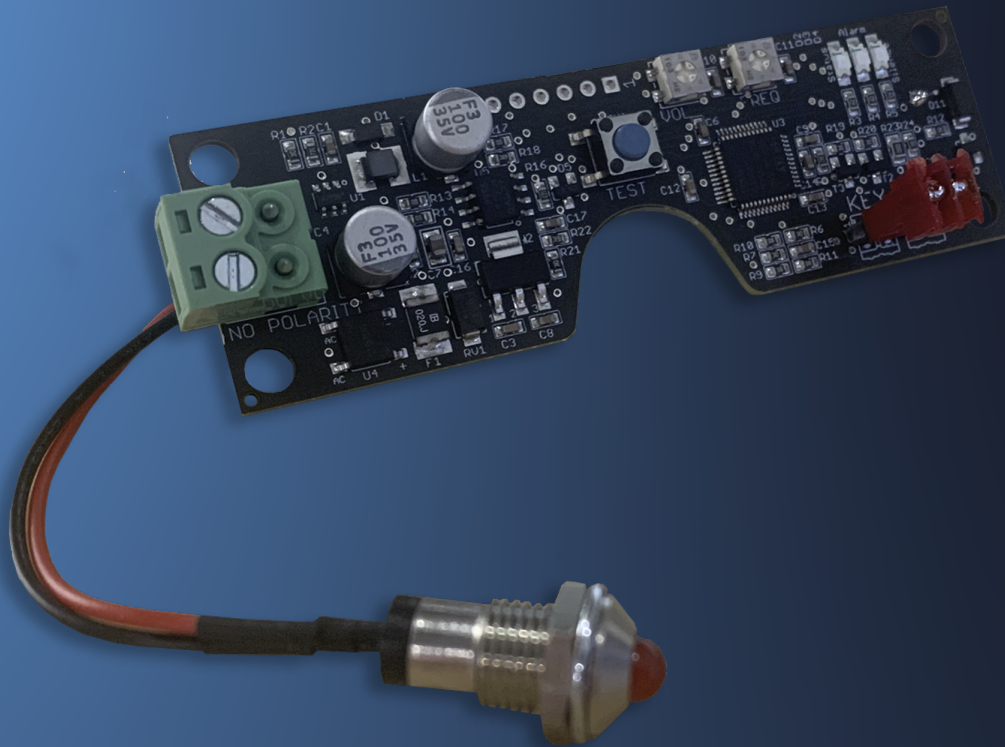

Features and Benefits

- Audible buzzer for system fault
- Visual indication of system fault
- Key switch to silence audible alarm
 - LED indicator included
- ASME A17.1-2019/CSA B44:19 compliant



917 Mgr Grandin, Suite 304B
Quebec City
Quebec, Canada
G1V 3X8
1 418 476-4802
info@vidatech.ca